

SADDLEMEN®

W W W . S A D D L E M E N . C O M

USER GUIDE & INSTALLATION INSTRUCTIONS

| | | |
|---------------------|---------------------------|----------------------|
| DESCRIPTION: | Tunnel Tail Bag | PART NUMBERS: |
| | TS1450R Standard | 3516-0108 |
| | TS1620S Wide | 3516-0109 |
| | TS1450R Tactical Standard | 3516-0271 |
| | TS1620S Tactical Wide | 3516-0272 |



OVERVIEW:

- Standard width tunnel bags fit motorcycles with a 9-inch wide or smaller rear seat/pillion.
- Exterior dimensions: 15" L x 17.5" W x 11" H. Tunnel is 9" wide in front, tapering down to 6" in the rear x 3" D x 15" L.
- Wide tunnel bags fits motorcycles with a 12" wide or smaller rear seat/pillion.
- Exterior dimensions: 15" L x 21" W x 11" . Tunnel is 12" wide in front tapering down to 9" in the rear x 3" D x 15" L.
- Includes an easy-to-use, universal, rear seat mounting system that easily attaches to most rear seats and pillion pads.
- Large main compartment is spacious enough for laptop or notebook computer, with three internal pockets.
- Internal tech organizer perfect for smartphones, digital cameras, or music players.
- Adjustable main compartment clamshell straps can be opened a full 180-degrees.
- Three big exterior pockets allow easy access to items on the go, two of which expand an additional two-inches for extra storage.
- Water-resistant construction with an integrated rain cover, so no matter what the weather, you're prepared.
- Thirteen exterior D-rings provide huge flexibility in attaching items to the bag such as jackets or other luggage.
- Six concealed D-rings are easy to use, but without any danger of scratching your bike's finish.
- Comfortable carry handle allows the bag to be used like a suitcase when off the bike.
- SaddleTuff™ 1200 denier, high durability fabric and semi-rigid construction holds shape and looks great even when empty.

CONTENTS / PARTS INCLUDED:

| <u>Qty</u> | <u>Item</u> | <u>Qty</u> | <u>Item</u> |
|------------|--------------------------------------|------------|--------------------------------------|
| 1 | Tunnel Tail Bag w/rain cover | 4 | Pull down/Shoulder straps (w/ clips) |
| 1 | Mounting Pad | 1 | Instructions |
| 2 | Mounting harness straps (w/ D-rings) | | |

IMPORTANT:

Please read these instructions completely before starting installation. All "NOTE," "CAUTION" and "WARNING" notations are serious safety issues and should be read carefully. Possible injury to riders or damage to the motorcycle and/or accessory may result if improperly installed.

NOTICE TO DEALERS:

These instructions contain important information for future reference and should be given to the customer.

IS-4110527 Tunnel Tail Bag (Rev 2 04-23)

⚠ WARNING:

READ THESE INSTRUCTIONS THOROUGHLY BEFORE INSTALLATION!

Because of the variety of motorcycle configurations, other accessories, and the features and intended use of this Saddlemen accessory luggage, there can be many different mounting options. You are responsible for the proper installation of this accessory on your motorcycle. Your attention to these installation instructions and recommendations will permit safe and proper use of this accessory. You must mount this accessory properly and securely before riding your motorcycle. If you lack the ability to safely and properly install this accessory, seek out a qualified motorcycle technician for assistance. During installation, support the motorcycle with a suitable stand or lift so it will not tip over and injure you, or damage the vehicle. Using or mounting this accessory improperly could result in a loss of control of the motorcycle which could result in damage to your motorcycle or other personal property, the property of third parties, and/or personal injury to yourself or others, up to and including death.

BE SURE TO THOROUGHLY READ AND CLOSELY FOLLOW THE MOUNTING INSTRUCTIONS INCLUDED WITH THIS ACCESSORY BAG

- The bag must be installed and securely fastened onto the seat or the luggage rack of the motorcycle.
- Install the bag securely so it will not shift or move while riding. Make sure the mounting straps or the bag will not contact the wheels, suspension or any other moving parts of the motorcycle.
- Thoroughly inspect your motorcycle luggage before every ride. Do not use this bag if the mounting system has been modified, has deteriorated, loosened or is beginning to fail.
- Before riding, secure your cargo inside the bag and completely close any lid or flap.
- Continually check the security of the bag at each stop as you ride. Straps can loosen during operation, so be sure to check them frequently.
- Do not use this accessory if you have any doubts as to whether it is properly mounted to your motorcycle.
- Do not exceed 10 pounds of total weight of the bag and its contents.
- Do not transport or store flammable or potentially explosive materials in your bag.
- When using this accessory, do not exceed your vehicle's Maximum Gross Vehicle Weight as listed on your motorcycle or in the manufacturer's owner's manual. Do not exceed the cargo capacity of each bag as listed on its attached warning label.
- If your bag is ever damaged, do not use it until it has been inspected by your local professional motorcycle dealer. Replace the bag immediately if it has sustained damage that will prevent it from being properly secured to your motorcycle or being able to securely hold its contents.
- Park the motorcycle on a hard, level surface and turn off the ignition before installation or securing any part of this product or items that might be attached to this product.
- DO NOT connect any mounting straps or any additional securing straps to flexible or moving parts (rubber mounted turn signals, swing arm, shocks, wheels etc.)

DO NOT ATTEMPT TO USE THIS ACCESSORY BAG IF:

- You do not understand these installation and use instructions;
- You do not understand any part of the accessory mounting system;
- You have any doubts as to the security of the mounting system.

If you do not understand these mounting instructions DO NOT mount the accessory, and remove any related items you may have installed on your vehicle. Contact your local professional motorcycle dealer for assistance, or call the Saddlemen support line at (310) 638-1222.

Remember: Motorcycling can be a dangerous activity. Installation of any accessory can increase your risk if it is not installed properly. You are responsible to install this accessory so it will not contact any portion of the drive train, suspension or steering, and so that it will in no way interfere with the operation of your motorcycle.

To avoid injury, install while engine is cold.

INSTALLATION:

Your Saddlemen Tunnel Tail Bag has been designed to mount on a variety of motorcycles using the included mounting pad and D-ring strap system that attaches the bag to the bike's rear seat. You (or your professional motorcycle technician) will need to determine the best mounting configuration for your motorcycle or scooter.

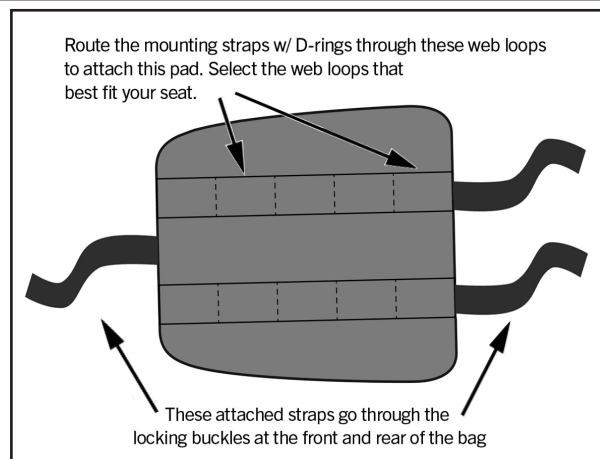

IS-4110527 Tunnel Tail Bag (Rev 2 04-23)

INSTALLATION *(continued)*

Remove the seat from the vehicle. Set the mounting pad (1) so it is centrally located on top of the rear seat and will be behind the rider.

Select two sets of loops (2) on the mounting pad that will best route the D-ring mounting straps (3) around the seat in a symmetrical pattern.

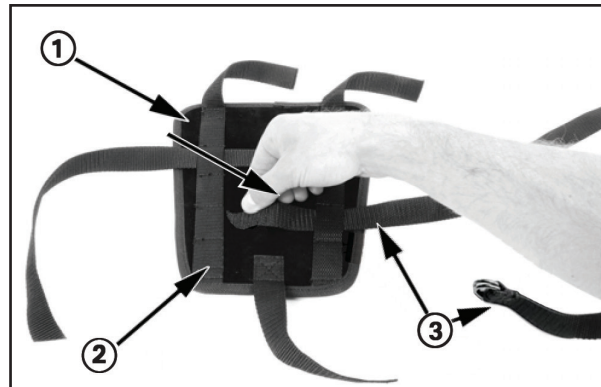

Loop and tighten the two mounting straps through their D-rings (4) on the underside of the passenger seat. Pass the end of the mounting strap up through both D-rings; pass the strap over the top D-ring and through the bottom D-ring and pull on the strap's end (5) to cinch it tight to the seat.

IMPORTANT: When routing the mounting straps around the seat, take care so the straps will not interfere with any possible seat mounting tab (6) or retention latch (7) components. Interference from a mounting strap could prevent the seat from being properly secured on the vehicle.

Attaching the mounting pad properly to the seat is essential for the bag to stay securely attached to the motorcycle during rough riding conditions.

After installing the mounting pad, cut off or secure any excess mounting strap material so it will not interfere with the motorcycle's seat latch, controls, suspension, wheels or other components.

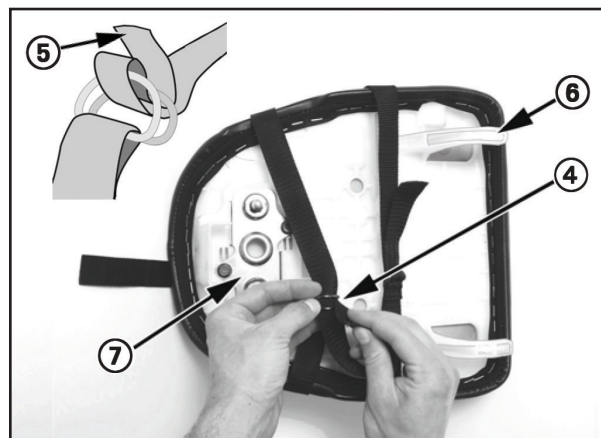

Replace the seat, with the mounting pad (1) installed, back onto the motorcycle.

Temporarily set the bag onto the seat to see if any portion of the bag will touch the body work of the motorcycle. If so, install protective tape on the bodywork (2) to protect the painted finish (Saddlemen offers a protective tape kit, available from your dealer; please order Saddlemen #4320-0807)

IMPORTANT: After installing the seat, lift up on the seat to make sure it is securely attached to the motorcycle.

NOTE: The mounting pad's strap tension should be checked and may have to be adjusted after installation of the seat. Verify the mounting pad is securely fastened when the seat is properly attached to the motorcycle's chassis.

Set the bag in place on the seat. The pad will have two retention straps coming out the front, and one retention strap from the rear. Route these retention straps (3) up through the corresponding camlock buckles (4) on the front and rear of the bag.

Pull the straps (3) up through each buckle to make sure the bag is pulled snugly to the seat before you fold the buckle's locking lever (4) into place.

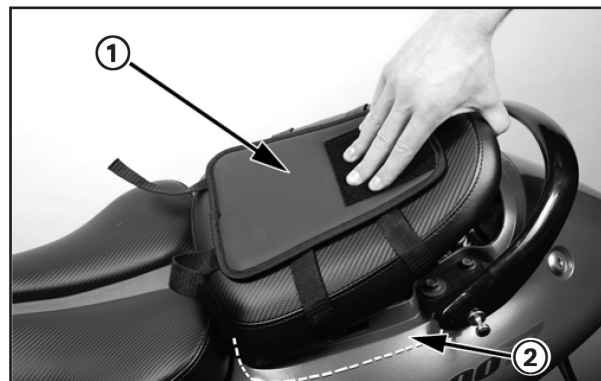

IS-4110527 Tunnel Tail Bag (Rev 2 04-23)

INSTALLATION *(continued)*

In addition to the three retention straps, the bag is also secured to the mounting pad via hook-and-loop fastener material on the top of the mounting pad and on the underside of the tunnel area of the bag. As you are installing the bag on the motorcycle, press down on the bag to engage the hook-and-loop fastener material.

NOTE: The bag can also be secured to a vehicle using the four supplied pull down straps. These straps have quick-release buckles and snap-hooks to permit a variety of mounting options on vehicles with different chassis configurations. These straps can also serve as shoulder or carrying straps when carrying the bag off the vehicle.



RAIN COVER

In case of inclement weather, zip open the rain cover pocket (6) at the front of the bag. Pull the cover out of the pocket and open it to cover the bag.

To seal the rain cover around the bag, cinch the cord (7) at the base of the cover. This will prevent the cover from billowing or coming off the bag as you ride.

IMPORTANT: Cut off or secure any excess mounting strap or rain cover cinch cord material so it will not get drawn into, or interfere with the motorcycle's controls, suspension, wheels or other components.

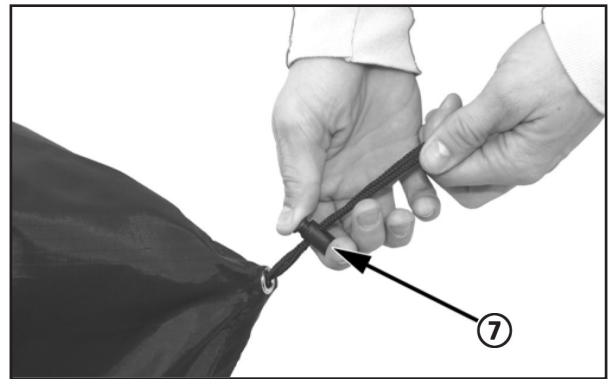

FEATURES:

- A. Seat tunnel: 9-inch wide (standard bag) or 12-inch wide (wide bag).
- B. Main Compartment: Large object, laptop or notebook computer storage
- C. Three exterior pockets
- D. Two expanding exterior pockets
- E. Integrated rain-cover
- F. Thirteen exterior D-rings (for attaching items to the bag such as jackets or other luggage)
- G. Three internal pockets
- H. Tech organizer (for smartphones or other personal electronics)
- I. Adjustable main compartment clamshell straps-can be opened a full 180-degrees.



IS-4110527 Tunnel Tail Bag (Rev 2 04-23)

WARNING:

Failure to install this accessory bag properly may allow portions of the bag or its mounting straps to contact the vehicle's moving parts. It is vital that you verify that the accessory and/or any of its parts will not touch, or interfere with other components while the suspension moves through its entire stroke. Make sure that your Tunnel Tail Bag does not touch the exhaust or other non-moving components, as well, as they may be damaged from contact with the accessory. Occasionally, the configuration of this accessory bag with certain motorcycles may require relocation and/or adjustment of certain components on the vehicle. Check to be sure that all lights and safety reflectors are visible once the bag is in place. If the bag blocks any side reflectors, place reflectors on the exterior sides of the bag (reflectors with self-adhesive backing are available from motorcycle or automobile supply stores). It is your responsibility to make sure the installation does not create an unsafe or illegal situation.

CAUTION:

After 50 miles (80 kilometers) of riding, recheck the accessory bag and the mounting straps to make sure that they are still tight and secure. Inspect the bag and its mounting hardware more often if you are riding your motorcycle in wet or rough conditions. Inspect the bag and related hardware before and during each ride. A loose accessory bag and/or mounting hardware can interfere with the vehicle's operation and cause an unsafe riding condition.

NOTE:

CARE OF YOUR SADDLEMEN BAG

Your Saddlemen bag requires almost no maintenance other than periodic cleaning with mild soap and water and the application of a UV inhibitor to prevent color fading caused by UVA and UVB sun exposure. We recommend Ray Bloc® Fabric Protector or similar which can be purchased online or at your local home improvement store. Fading due to lack of maintenance is not covered by warranty.

LIMITED WARRANTY POLICY

SADDLEMEN LIMITED ONE-YEAR WARRANTY Saddlemen warrants its products for defects in materials, design or workmanship for a period of one year after retail purchase. Items that are defective will be repaired or replaced by Saddlemen at its sole discretion. Damage caused by improper use or improper installation is not a defect; therefore repair, replacement or shipping of a damaged accessory will not be covered under this warranty. This limited warranty contains other provisions and conditions, so please refer to the Warranty Policy that was provided with your Saddlemen luggage, or visit www.saddlemen.com for additional information. You can count on Saddlemen's quality, innovation, service and style. If for any reason you are not satisfied with the performance of your Saddlemen product, please contact the Saddlemen support line at (310) 638-1222.

IS-4110527 Tunnel Tail Bag (Rev 2 04-23)



17801 SOUTH SUSANA ROAD, RANCHO DOMINGUEZ, CA 90221

| PH: 310.638.1222