

## USER GUIDE & INSTALLATION INSTRUCTIONS

**DESCRIPTION:** Cruis'n 3-Pocket Windshield Bag  
**PART NUMBER:** 3508-0015  
**FITMENT:** Harley-Davidson® 1996-2013  
FLHT/FLHX models with bat-wing fairing



### IMPORTANT:

Please read these instructions completely before starting installation. All "NOTE," "CAUTION" and "WARNING" notations are serious safety issues and should be read carefully. Possible injury to riders or damage to the motorcycle and/or accessory may result if improperly installed.

### NOTICE TO DEALERS:

These instructions contain important information for future reference and should be given to the customer.

### ⚠ WARNING:

**READ THESE INSTRUCTIONS THOROUGHLY BEFORE INSTALLATION!**

Because of the variety of motorcycle configurations, other accessories, and the features and intended use of this Saddlemen accessory, there could be many different mounting options. You are responsible for the proper installation of this accessory on your motorcycle. Your attention to these installation instructions and recommendations will permit safe and proper use of this accessory. You must mount this accessory properly and securely before riding your motorcycle. If you lack the ability to safely and properly install this accessory, seek out a qualified motorcycle technician for assistance. During installation, support the motorcycle with a suitable stand or lift so it will not tip over and injure you, or damage the vehicle. Using or mounting this accessory improperly could result in a loss of control of the motorcycle which could result in damage to your motorcycle or other personal property, the property of third parties, and/or personal injury to yourself or others, up to and including death.

**BE SURE TO THOROUGHLY READ AND CLOSELY FOLLOW THE MOUNTING INSTRUCTIONS THAT ARE INCLUDED WITH THIS ACCESSORY:**

- The bag must be installed and securely fastened onto the fairing cowl of your motorcycle.
- When mounted, make sure your bag does not obscure your view of the road or surroundings.
- For your safety, install the bag securely so it will not shift or move while riding. Make sure the mounted bag will not contact the controls or any other moving parts of your vehicle.
- Thoroughly inspect your bag before every ride. Do not use this bag if it has been modified, or has deteriorated, loosened or is beginning to fail.
- Before riding, secure and protect your cargo inside the bag (use special care to protect eye wear) and completely close any lid or flap.
- Do not exceed one pound of total cargo weight, including the weight of the bag itself.
- Do not use this accessory if you have any doubts as to whether it is properly mounted to your motorcycle.
- Do not transport or store flammable or potentially explosive materials in your bag.
- Continually check the security of the bag at each stop as you ride. Hardware on a motorcycle can loosen during operation, so be sure to check it frequently.
- When using this or any accessory, do not exceed your vehicle's Maximum Gross Vehicle Weight as listed in your vehicle's owner's manual.
- If your bag is ever damaged, do not use it until it has been inspected by your local professional motorcycle dealer. Replace the bag immediately if it has sustained damage that will prevent it from being properly secured to your motorcycle or being able to securely hold its contents.

**DO NOT ATTEMPT TO USE THIS ACCESSORY IF:**

- You do not understand these installation and use instructions;
- You do not understand any part of the accessory mounting system;
- You have any doubts as to the security of the mounting system.

If you have any concerns or questions, seek help at your qualified motorcycle dealer or call the Saddlemen support line at (310) 638-1222.

## ⚠ WARNING:

Remember: Motorcycling can be a dangerous activity. Installation of any accessory can increase your risk if it is not installed properly. You are responsible to install this accessory bag so it will not contact any portion of the steering, suspension or drive train, and so it will in no way interfere with the operation of your motorcycle.

To avoid injury, install while engine is cold.

## INSTALLATION:

Your Saddlemen Windshield Bag is designed to slip in between the windshield and the inner dash of your motorcycle's fairing. You (or your professional motorcycle technician) will need to take care when mounting the bag so it is firmly secured to the motorcycle.

Please refer to the illustration to the right. Remove the three screws (1) (in some cases you may only need to loosen the screws rather than completely remove them) that secure the windshield molding (2) to the outer fairing cowl (3). This will also permit the outer cowl to separate away from the windshield (4) and the inner dash (6).

Slide the lower, backing portion of the windshield bag (5) down between the inner dash and the windshield. Align the holes in the windshield molding, the outer cowl and the windshield with the slots of the windshield bag and the threaded nut in the inner dash. Once all the parts are aligned, reinsert the screws.

**IMPORTANT** Loosely install the three screws as you check the fit and alignment of the windshield and the bag before tightening the screws securely. Refer to the windshield mounting instructions in your motorcycle's owner's or service manual. In some cases, depending upon the windshield and its molding, you may need to install longer windshield mounting screws when installing your bag. In that case, seek the assistance of your local motorcycle dealer for parts or technical support.

**NOTE** If you remove the left storage pocket (7) to make room for a GPS mounted to the dash, use the supplied snap covers to cover the male snaps (8) on the bag's foundation to improve the appearance.

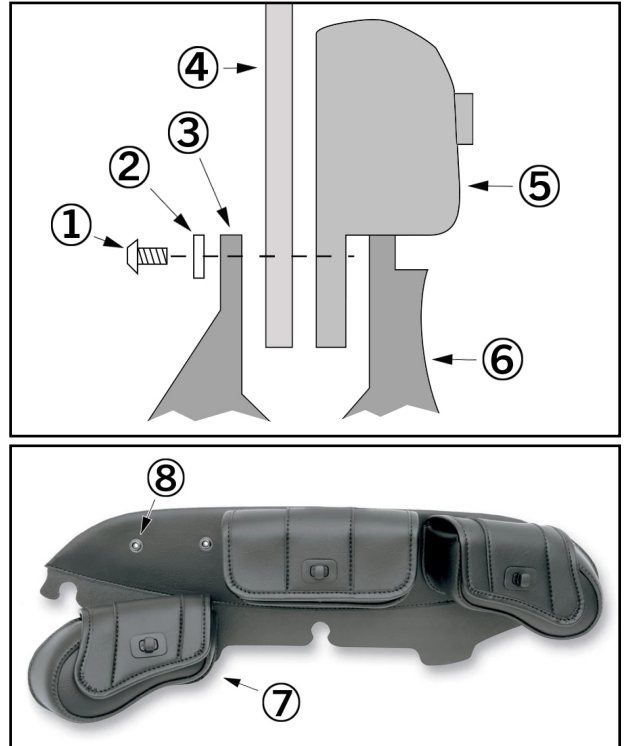

## CAUTION:

Failure to install this accessory properly may allow portions of the bag or its mounting materials to contact the vehicle's moving parts. It is vital that you ensure that this accessory and/or any of its parts will not touch, or interfere with other components throughout the vehicle's entire range of motion, including steering. **DO NOT** connect any straps to flexible or moving parts (items such as rubber mounted turn signals, swingarm or shock absorbers). Make sure that your windshield bag does not interfere with any other non-moving parts, as well, as they may be damaged from contact with this accessory.

After 50 miles (80 kilometers), recheck the mounting of the bag to make sure it is still securely attached to the fairing. Inspect the bag and its mounting before and during each ride. A loose bag can interfere with the vehicle's operation and cause an unsafe riding condition.

## NOTE:

**CARE OF YOUR SADDLEMEN BAG** Your Saddlemen bag requires almost no maintenance other than periodic cleaning.

## LIMITED WARRANTY POLICY

**SADDLEMEN LIMITED ONE-YEAR WARRANTY** Saddlemen warrants its products for defects in materials, design or workmanship for a period of one year after retail purchase. Items that are defective will be repaired or replaced by Saddlemen at its sole discretion. Damage caused by improper use or improper installation is not a defect; therefore repair, replacement or shipping of a damaged accessory will not be covered under this warranty. This limited warranty contains other provisions and conditions, so please refer to the Warranty Policy that was provided with your Saddlemen luggage or visit [www.saddlemen.com](http://www.saddlemen.com) for additional information. You can count on Saddlemen's quality, innovation, service and style. If for any reason you are not satisfied with the performance of your Saddlemen luggage, please contact the Saddlemen support line at (310) 638-1222.

33 - 400219 (Rev.12-21)